



SCL K07 / K08 / K09 / K10

MS SERIES

SN1805-19B 1/2

TECHNICAL CHARACTERISTICS

- Aluminium alloy construction
- Smooth operation
- High efficiency impeller
- Maintenance free
- Mountable in any position
- Recognized TEFC - cURus motor

OPTIONS

- Special voltages (IEC 38)
- Surface treatments

ACCESSORIES

- Inlet and/or inline filters
- Additional inlet/outlet silencers
- Safety valves
- Flow converting device
- Optional connectors

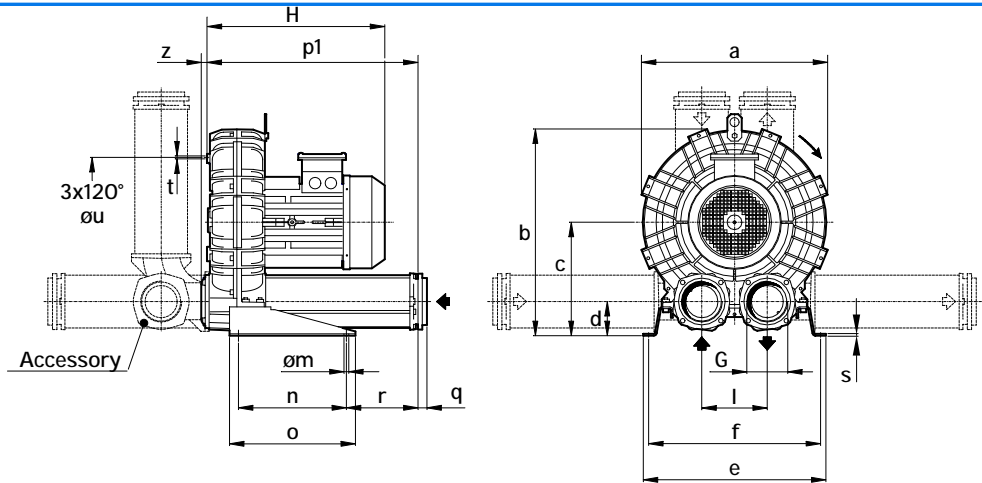

Dimensions in inches.
Dimension for reference only.

| Model | a | b | c | d | e | f | G | l | m | n | o | p1 | q | r | s | t | u | z |
|--------|-------|-------|-------|------|-------|-------|--------|------|------|-------|-------|-------|------|------|------|----|-------|------|
| K07-MS | 16.69 | 18.84 | 10.59 | 3.23 | 18.43 | 17.24 | 3" NPT | 6.10 | 0.51 | 11.81 | 13.78 | 20.16 | 0.98 | 5.39 | 0.20 | M8 | 11.61 | 0.63 |
| K08-MS | 17.99 | 19.61 | 10.59 | 3.23 | 18.82 | 17.64 | 3" NPT | 6.10 | 0.51 | 11.81 | 13.78 | 20.16 | 0.98 | 5.39 | 0.20 | M8 | 12.2 | 0.63 |
| K09-MS | 19.37 | 22.09 | 12.40 | 3.78 | 20.00 | 18.82 | 4" NPT | 7.17 | 0.51 | 11.81 | 13.78 | 23.07 | 0.98 | 7.83 | 0.20 | M8 | 14.17 | 0.63 |
| K10-MS | 20.31 | 22.56 | 12.40 | 3.78 | 20.00 | 18.82 | 4" NPT | 7.17 | 0.51 | 11.81 | 13.78 | 23.07 | 0.98 | 7.83 | 0.20 | M8 | 14.17 | 0.63 |

| Model | Maximum flow Scfm | | Installed power Hp | | Maximum differential pressure Δp (In WG) | | Noise level Lp d B (A) ⁽¹⁾ | | Overall dimensions H Inches | Weight Lbs |
|--------|-------------------|-------------------|--------------------|-------------------|--|-------------------|---------------------------------------|-------------------|-----------------------------|------------|
| | 60 Hz 3500 rpm | 50 Hz 2900 rpm | 60 Hz 3500 rpm | 50 Hz 2900 rpm | 60 Hz 3500 rpm | 50 Hz 2900 rpm | 60 Hz 3500 rpm | 50 Hz 2900 rpm | | |
| K07-MS | 294 | 243 | 4 | 4 | 50 | 80 | 78.7 | 76.7 | 15.6 | 116.2 |
| | | | 5 1/2 | 5 1/2 | 80 | 110 | 79.0 | 77.0 | 16.3 | 119.0 |
| | | | 7 1/2 | 7 1/2 | 121 | 141 | 79.3 | 77.3 | 18.4 | 160.5 |
| | | | 10 | 10 | 171 | - | 79.6 | 77.6 | 19.1 | 172.6 |
| K08-MS | 381 | 316 | 5 1/2 | 5 1/2 | 40 | 70 | 79.7 | 77.7 | 16.3 | 124.8 |
| | | | 7 1/2 | 7 1/2 | 70 | 100 | 80.0 | 78.0 | 18.4 | 166.5 |
| | | | 10 | 10 | 111 | 141 | 80.3 | 78.3 | 19.1 | 179.0 |
| | | | 15 | 15 | 171 | 171 | 80.6 | 78.6 | 19.1 | 192.0 |
| K09-MS | 471 | 390 | 7 1/2 | 7 1/2 | 50 | 80 | 80.2 | 78.2 | 18.8 | 186.3 |
| | | | 10 | 10 | 80 | 120 | 80.5 | 78.5 | 19.5 | 199.0 |
| | | | 15 | 15 | 141 | 171 | 81.0 | 79.0 | 19.6 | 212.0 |
| | | | 20 | 20 | 171 | - | 81.3 | 79.3 | 22.0 | 245.0 |
| K10-MS | 556 | 460 | 7 1/2 | 7 1/2 | 30 | 60 | 80.1 | 78.1 | 18.8 | 189.6 |
| | | | 10 | 10 | 50 | 90 | 80.5 | 78.5 | 19.5 | 202.0 |
| | | | 15 | 15 | 111 | 141 | 81.0 | 79.0 | 19.6 | 215.0 |
| | | | 20 | 20 | 161 | 171 | 81.4 | 79.4 | 22.0 | 248.0 |
| | | | 25 | 25 | 201 | - | 81.6 | 79.6 | 24.0 | 322.0 |

(1) Noise measured at 1 m distance with inlet and outlet ports piped, in accordance to ISO 3744.

- For proper use, the blower should be equipped with inlet filter and safety valve; other accessories available on request.
- Ambient temperature from +5° to +104°F.
- Specifications subject to change without notice.



SCL K07 / K08 / K09 / K10 / K11 / K12

MS SERIES

SN1805-19B 2/2

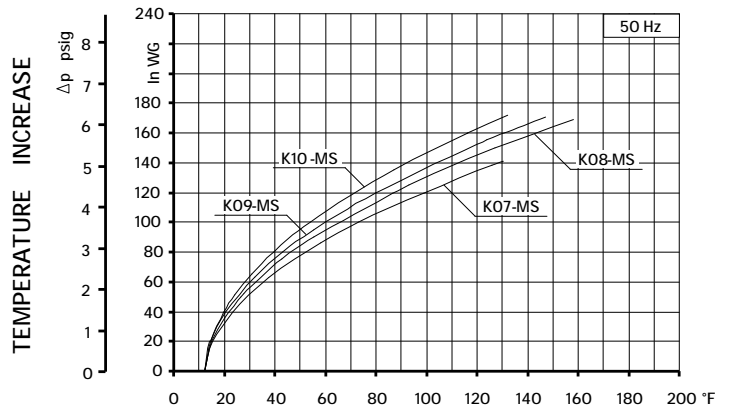
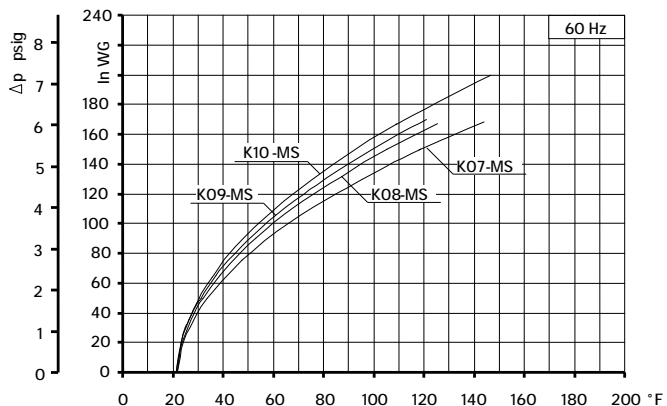
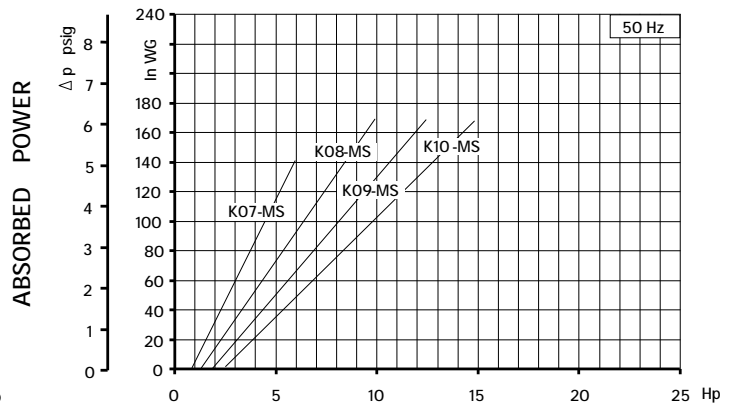
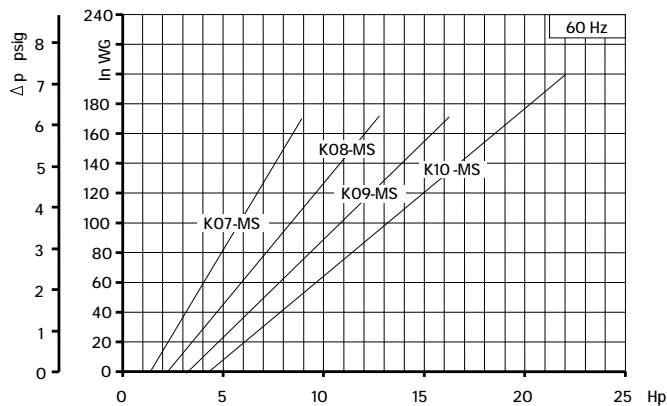
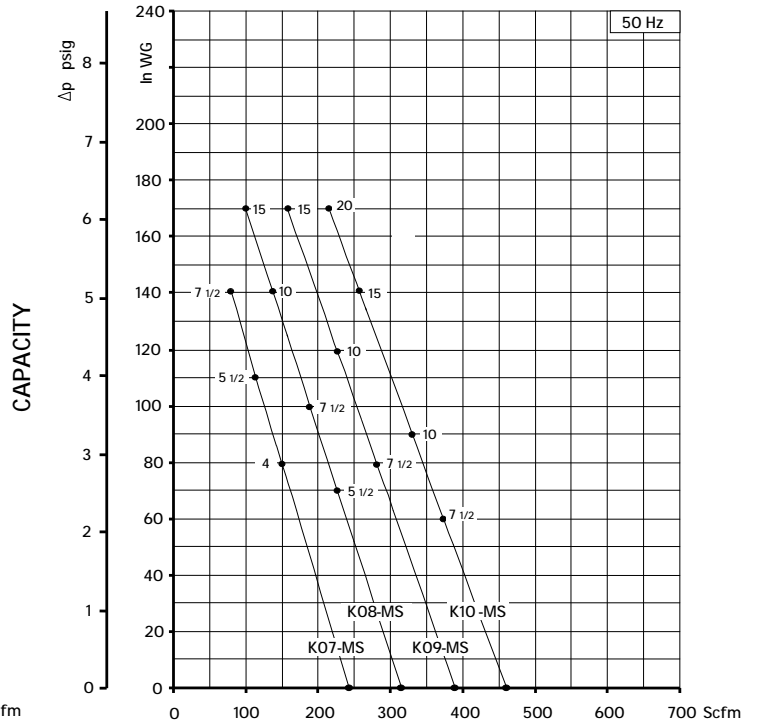
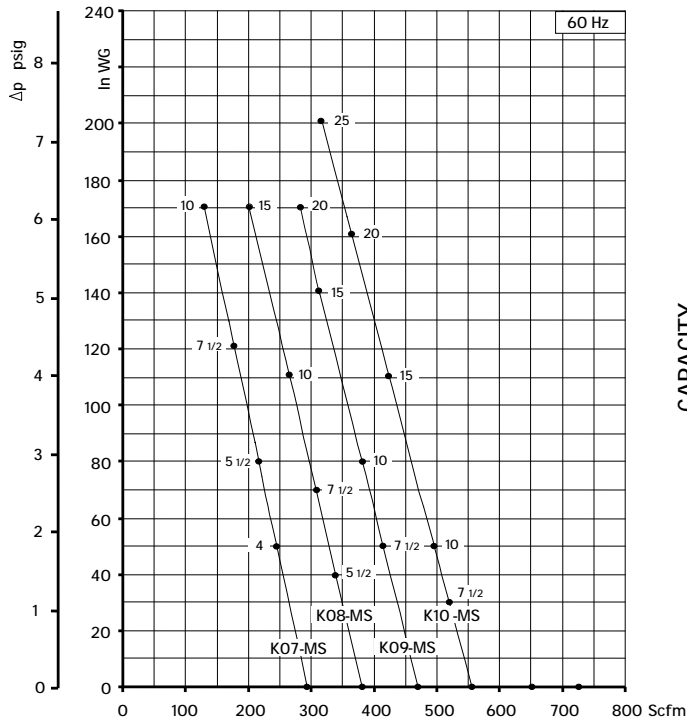

Curves refer to air at 68°F temperature and 29.92 In Hg atmospheric pressure (abs) measured at inlet port.
 Values for flow, power consumption and temperature rise: +/- 10% tolerance.
 Data subject to change without notice.